

Library Floor Maps

Hours (Fall & Spring Semesters):

Mon. – Thurs. 8 am – Midnight
 Friday 8 am – 6 pm
 Saturday 9 am – 8 pm
 Sunday 11 am – Midnight
 (Interim and holiday hours are posted)

Phone: Circulation: 520-4440
 Reference: 520-4441

Ground Floor:

Government Publications
 Library Instruction Classroom
 Technical Services

1st Floor

Audio/Video Room
 Circulation/Reserve Desk
 Computer Lab
 Interlibrary Loan Office
 Hammes Information Commons

2nd Floor:

Periodicals
 Special Collections

3rd Floor:

Administrative Offices
 Stacks A–G
 Conference Room
 Lincoln Room

4th Floor:

Stacks H–N
 Group Study Rooms
 Seminar Room

5th Floor:

Stacks P–Z
 Group Study Room
 Oversize Books

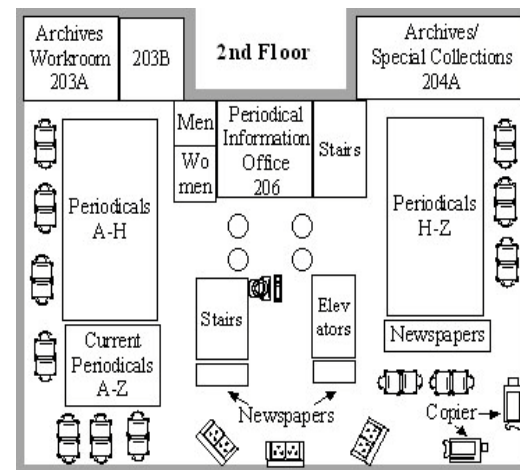
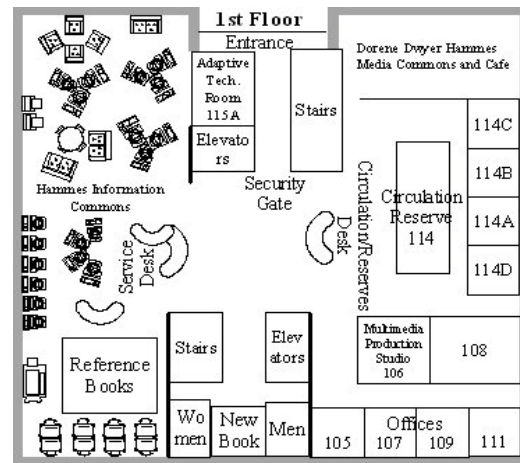
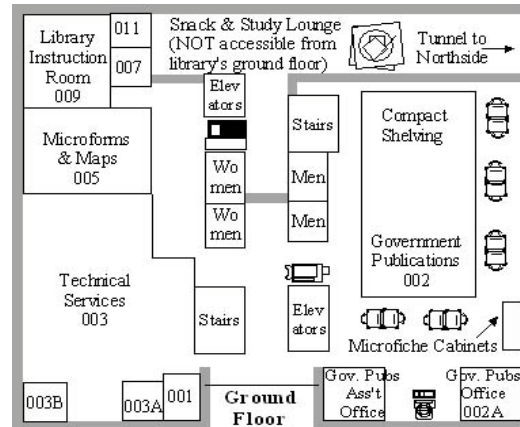

Copiers are located on the Ground, First, and Second floors.

Library of Congress Classification:

A General Works

- AE Encyclopaedias
- AY Yearbooks

B Philosophy, Psychology, Religion

- BF Psychology
- BL–BX Religion

C History

- CC Archaeology
- CT Biography

E–F History: Americas

G Geography, Anthropology

- G Geography
- GN Anthropology

H Social Sciences

- HA Statistics
- HB–HJ Economics
- HF Commerce
- HM Sociology
- HQ Marriage, Family, Women

J Political Science

- JA General Works
- JC Political Theory
- JF Constitutional History
- JK United States

K Law

- KD English Law
- KF United States Law

L Education

- LA History of Education
- LB Theory & Practice
- LD–LG Indiv. Institutions

M Music

- ML Literature of Music
- MT Musical Instruction & Study

N Fine Arts

- NB Sculpture
- NC Graphic Arts
- ND Painting

P Language & Literature

- PC Romance Languages
- PD Germanic Languages
- PE English Language
- PN Literary History
- PQ Romance Literatures
- PR English Literature
- PS American Literature
- PT Germanic Literatures
- PZ Juvenile Literature

Q Science

- QA Mathematics
- QC Physics
- QD Chemistry
- QK Botany

R Medicine

- RK Dentistry
- RT Nursing

S Agriculture; Technology

Z Bibliography; Z Library Sciences

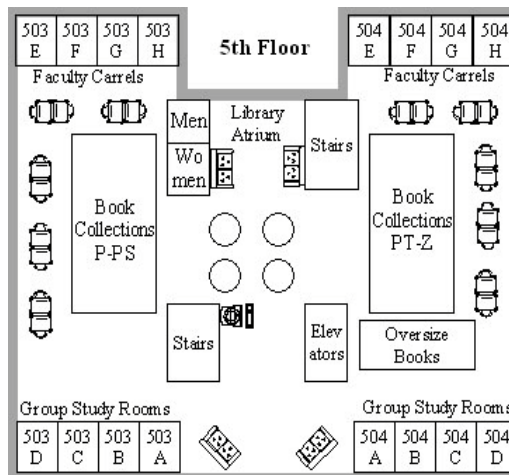
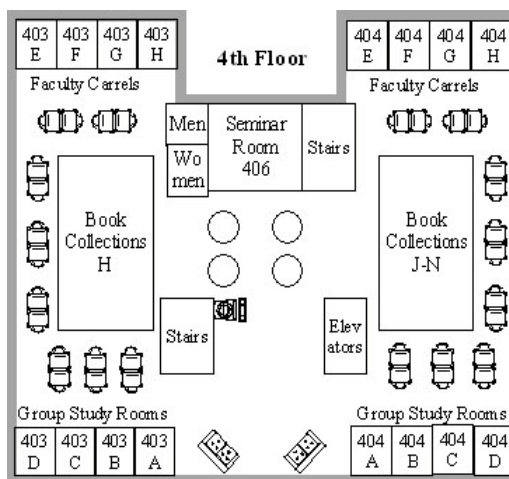
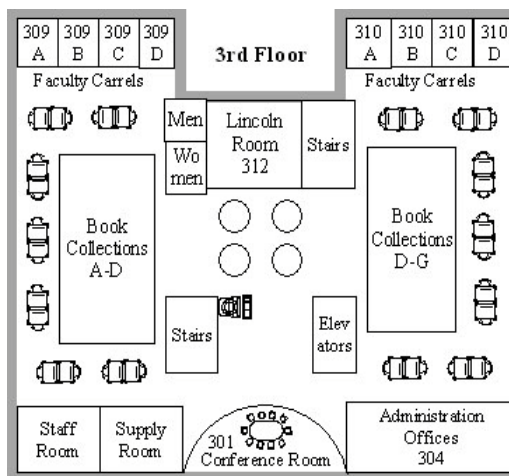

If you have a disability and need assistance, special arrangements can be made to accommodate most needs. Please contact Julie Elliott at 520-4410 for assistance.